

Grand Banquet Room



Concord Ballroom

Concord Ballroom, 5th floor

This vast 1,320-square-meter (14,208-square-foot) room is large enough to accommodate up to 1,000 people for an elegant sit-down dinner, or up to 1,500 people for a buffet or other standing event.

Area 1320sqm, Height 6.0m

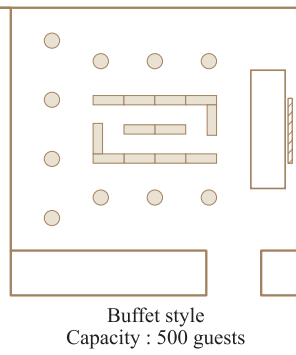
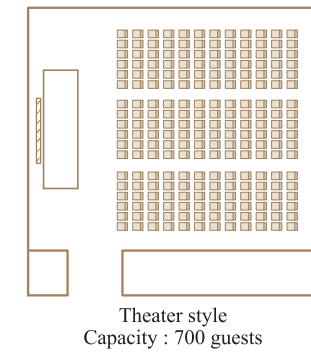
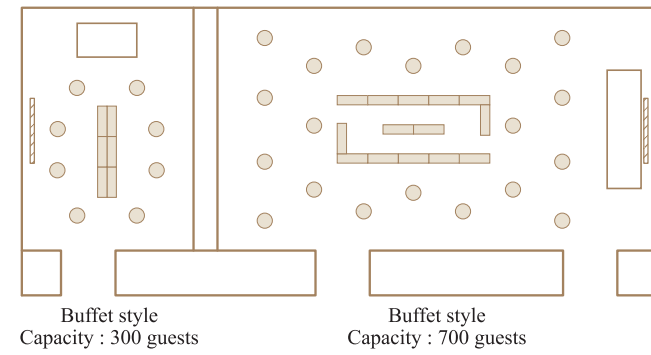
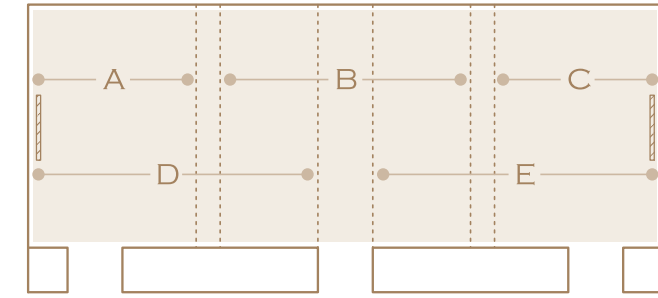

Concord Ballroom Foyer

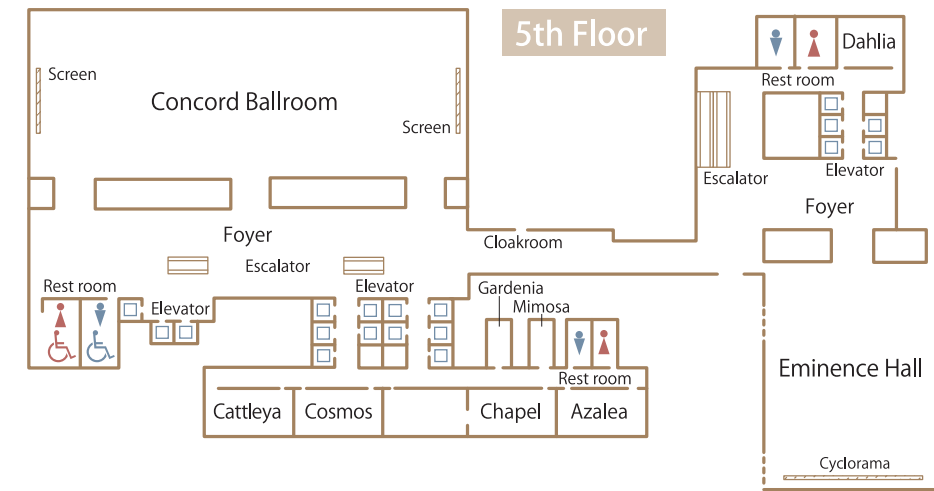

Eminence Hall Foyer

Eminence Hall, 5th floor

The Eminence Hall features a 6-meter (19-foot) high ceiling with dazzling chandeliers and lights that illuminate the tables in ever-changing colors. The large windows bring natural sunlight into the hall.

Area 715sqm, Height 6.0m



Eminence Hall

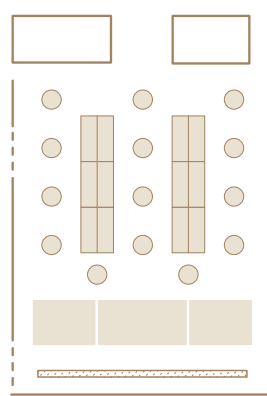

Buffet style
Capacity : 600 guests

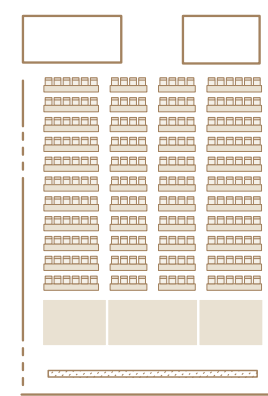

Classroom style
Capacity : 500 guests



Hana

Hana, 4th floor

Hana is a multipurpose four-room space with a capacity for 900 guests in theater-style seating. Hana is an ideal venue for conferences, seminars, lectures and exhibitions.

Area 960sqm, Height 3.5m

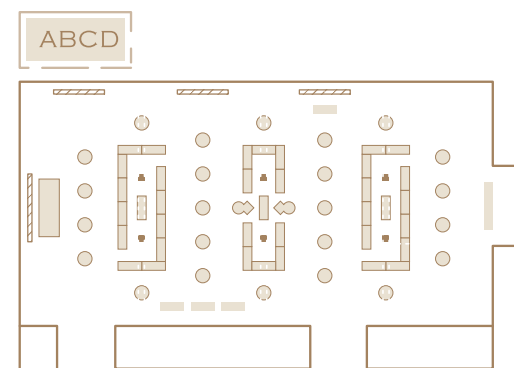
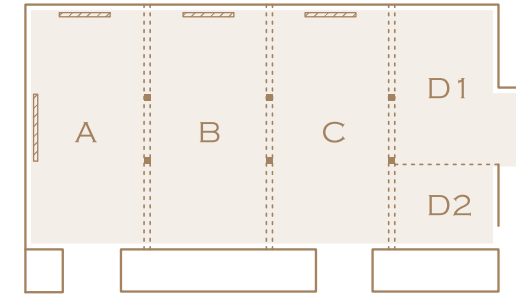

Buffet style
Capacity : 700 guests

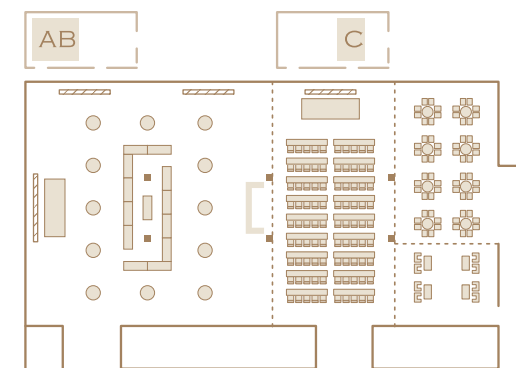

Buffet style
Capacity : 400 guests

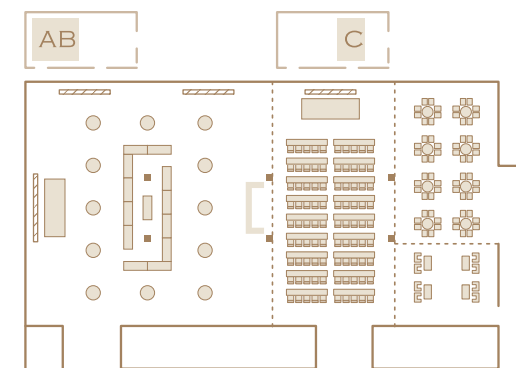

Classroom style
Capacity : 140 guests

Nishiki / Ohgi, 4th floor

Two of our midsize rooms, located on the fourth floor, offer just the right space and environment for receptions and other events. The windows bring natural sunlight into the Ohgi room.

Area 325sqm, Height 3.2m

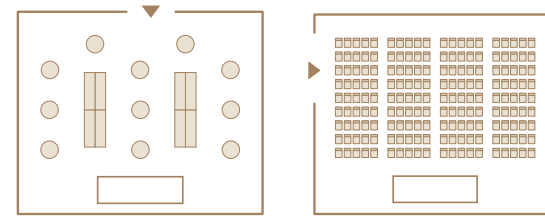

Buffet style
Capacity : 250 guests

Theater style
Capacity : 360 guests

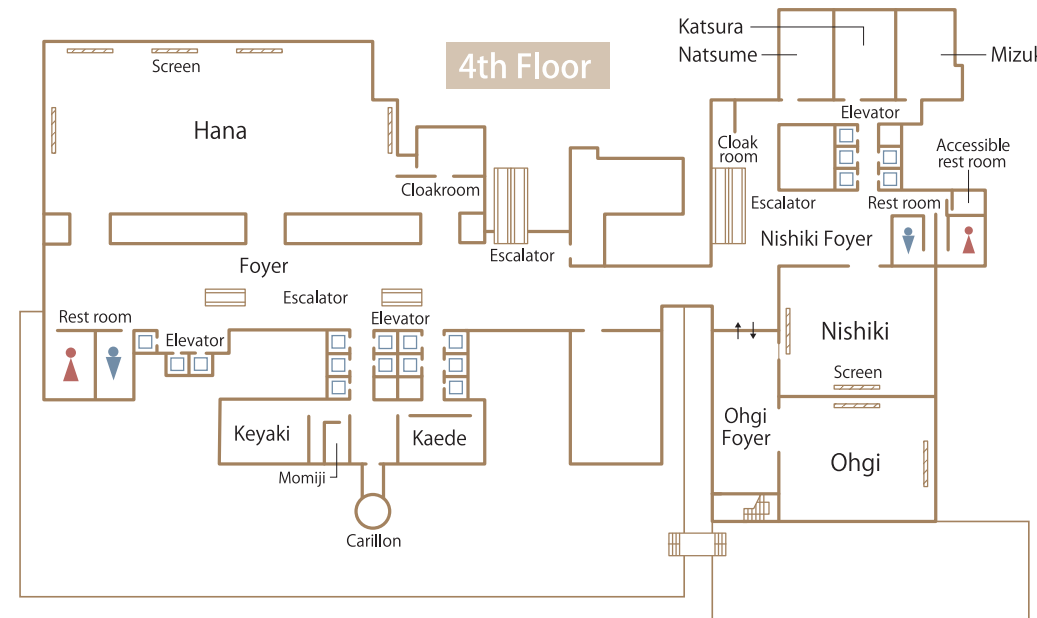

Nishiki



Ohgi

Sky Banquet Rooms

All of our banquet rooms on the higher floors (42nd, 43rd, 44th) offer magnificent city views. Keio Plaza Hotel has a wide selection of banquet rooms available that are ideal for breakfast or dinner meetings, lectures, conferences, reception parties and wedding receptions.



Tsukui



Musashi



Mitake

42nd Floor

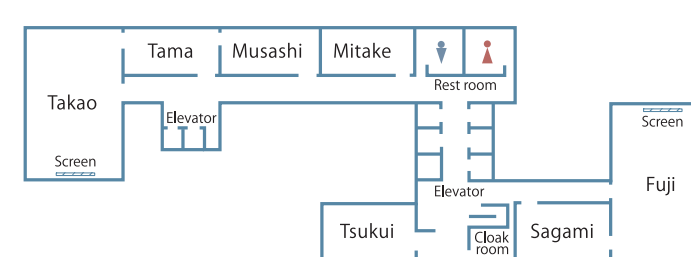

Takao



Fuji



Starlight



Moonlight

43rd Floor

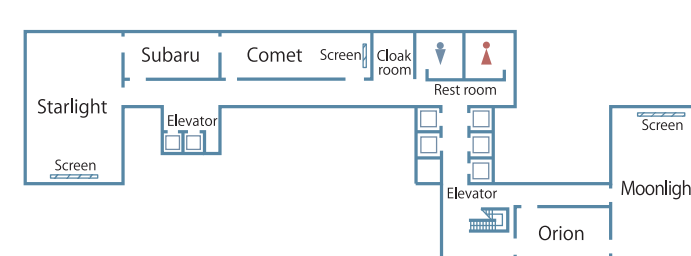

Ensemble



Harmony

44th Floor

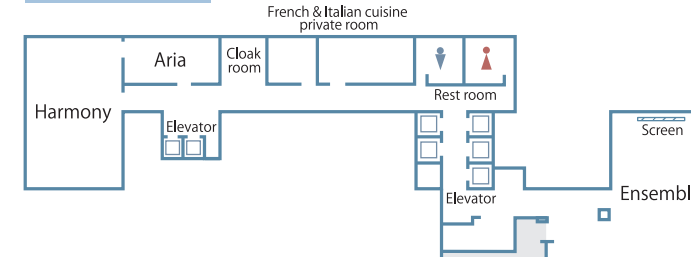

Capacity List

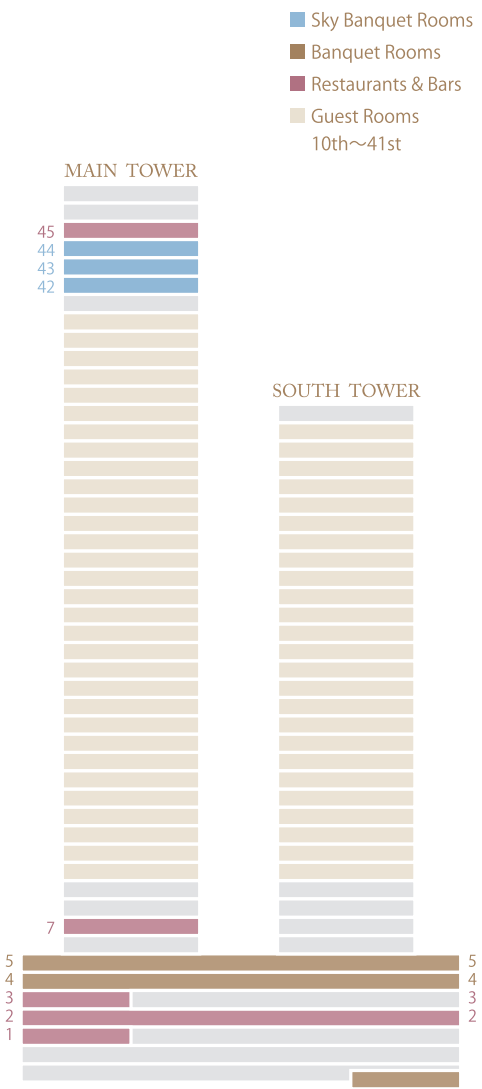

*Rooms can be split into several partitions

Floor	Room	Area	Dimension (WxD;m)	Ceiling height (m)	Conference		Dining		
					Classroom	Theater	Standing Buffet	Seated Dinner	Seated Buffet
44F	Ensemble	272 sqm	17 x 11.2	2.7	60	60	60	60	60
	Harmony	190 sqm	17 x 11.2	2.7	140	180	120	120	80
	Aria	67 sqm	11 x 5.5	2.7	30	40	40	30	20
43F	Starlight	190 sqm	17 x 11	2.7	140	180	120	120	80
	Subaru	67 sqm	11.5 x 5	2.7	30	40	40	30	20
	Moonlight	190 sqm	17 x 11	2.7	140	180	120	120	80
42F	Orion	67 sqm	11.5 x 5	2.7	30	40	40	30	20
	Comet	98 sqm	16.5 x 5	2.7	50	60	60	50	40
	Takao	188 sqm	17 x 11	2.7	140	180	120	120	80
5F	Tama	67 sqm	9.4 x 5	2.7	30	40	40	30	20
	Fuji	188 sqm	17 x 11	2.7	140	180	120	120	80
	Sagami	67 sqm	10.5 x 5	2.7	30	40	40	30	20
4F	Tsukui	67 sqm	10.5 x 5	2.7	30	40	40	30	20
	Mitake	67 sqm	10.5 x 5	2.7	30	40	40	30	20
	Musashi	67 sqm	10.5 x 5	2.7	30	40	40	30	20
5F	Concord Ballroom*	1,320 sqm	57 x 23	6.0	1,000	1,800	1,500	1,000	600
	AB, BC	835 sqm	36 x 23	6.0	650	1,050	700	500	450
	A, C	355 sqm	15.4 x 23	6.0	250	500	300	200	180
4F	B	436 sqm	19 x 23	6.0	360	540	400	250	200
	D, E	554 sqm	24 x 23	6.0	450	700	500	350	280
	Cattleya	67 sqm	11 x 6.1	2.7	-	-	-	-	-
3F	Cosmos*	67 sqm	11 x 6.1	2.7	30	40	-	-	-
	Azalea*	67 sqm	11 x 6.1	2.7	30	40	-	-	-
	Hana*	960 sqm	42.2 x 21.4	3.5	450	900	700	520	450
2F	ABC	748 sqm	33.3 x 21.4	3.5	400	850	600	420	420
	BCD	697 sqm	30.6 x 21.4	3.5	380	830	580	400	400
	AB, BC	485 sqm	21.9 x 21.4	3.5	240	500	400	310	240
1F	CD	450 sqm	19 x 21.4	3.5	200	450	350	250	220
	A, C	238 sqm	10.5 x 21.4	3.5	140	300	190	150	100
	D	189 sqm	7.7 x 21.4	3.5	100	200	120	100	80
0F	Keyaki	98 sqm	11.4 x 8.6	2.7	50	60	-	-	-
	Kaede*	67 sqm	11.4 x 5.8	2.7	30	40	-	-	-

*Rooms can be split into several partitions

Floor	Room	Area	Dimension (WxD;m)	Ceiling height (m)	Conference		Dining		
					Classroom	Theater	Standing Buffet	Seated Dinner	Seated Buffet
5F	Eminence Hall	715 sqm	23 x 30	6.0	500	800	600	450	350
	Dahlia*	50 sqm	8.3 x 6	2.7	-	-	-	-	-
4F	Nishiki	325 sqm	20 x 16	3.2	250	360	250	200	130
	Ohgi	325 sqm	20 x 16	3.2	250	360	250	200	130
	Natsume	85 sqm	7 x 11	2.4	40	50	40	30	30
	Katsura	85 sqm	7 x 11	2.4	40	50	40	30	30
3F	Mizuki	85 sqm	7 x 11	2.4	40	50	40	30	30
	Grace Room	300 sqm	9.5 x 21 6.0 x 16.5	2.8	144	180	140	-	80

Restaurants & Bars

Soujuan / Kaiseki Cuisine
Main Tower 2F



Kagari / Japanese Cuisine
Main Tower 2F



Yamanami / Teppan-yaki
Main Tower 7F



Shun / Tempura
Main Tower 7F



OTHER RESTAURANTS

- Duo Fourche ttes (French & Italian Cuisine)
- Glass Court (Super Buffet)
- Jur in (All Day Dining)
- Nan-En (Chinese Dining)
- Kyubey (Sushi)
- Fumotoya (Soba Cuisine)
- Poppins (Food Boutique)

BARS / LOUNGES

- Brilliant (Main Bar)
- Aurora (Sky Lounge)
- Amanogawa (Japanese Sake Bar)
- Cocktail & Tea Lounge (Lobby Lounge)
- Duet (Art Lounge)

LOCATION

The Keio Plaza Hotel is at the perfect location to explore the delights of the city of Tokyo. Just outside Tochomae Station or only 5-minute walk from Shinjuku Station, the most popular shopping and entertainment spots, our luxury hotel provides stunning experiences which will linger with guests for a long time.

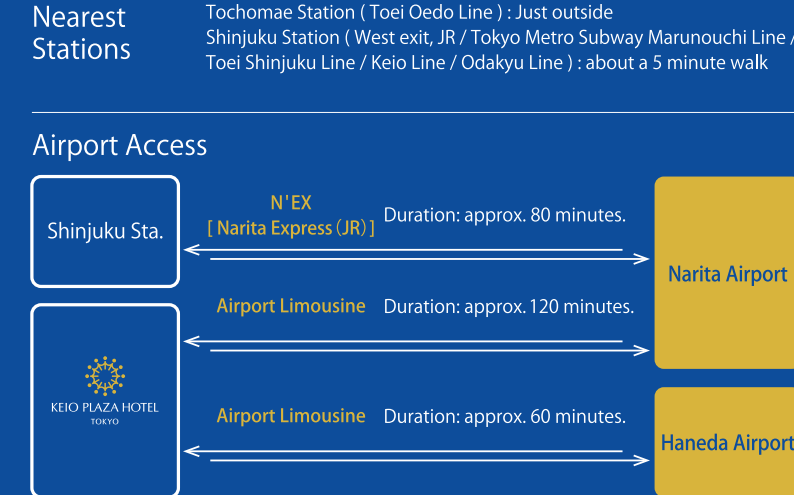
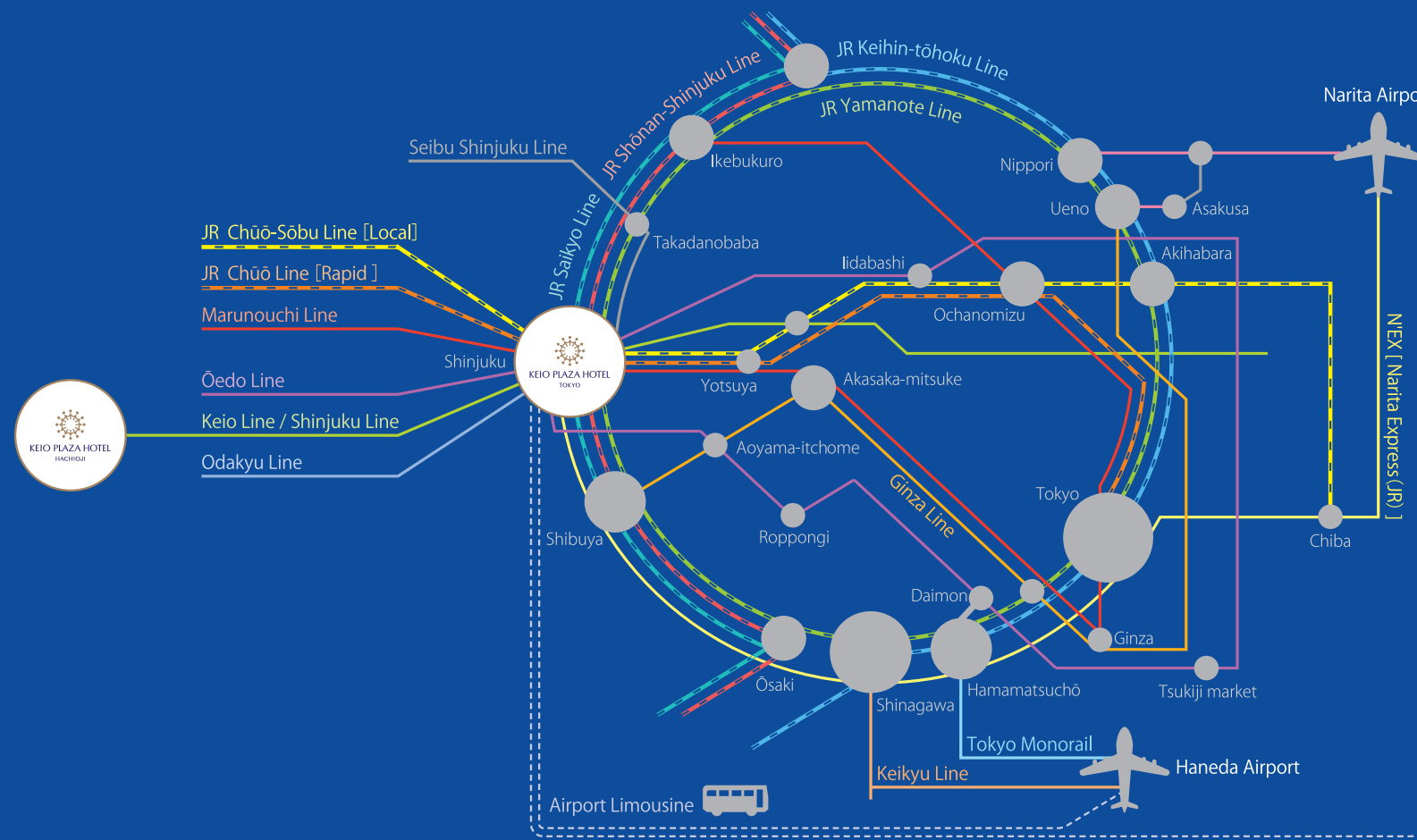

Other Facilities & Services

- Sky Pool (summer-only)
- Fitness Room
- Business Center
- Nursing Room
- Clinic
- Universal Design (Accessible) Room
- Food Boutique
- Convenience Store
- Reflexology
- Sightseeing Tours
- Good Neighbor Shuttle Bus (Complimentary shuttle bus service from our hotel to Tokyo Disneyland and Tokyo DisneySea only for overnight guests)
- Free Wi-Fi
- Currency Exchange
- Laundry service
- Items free charge for guest use (strollers and wheelchairs)
- Club Lounge

LIFESTYLE



2-2-1 Nishi-Shinjuku, Shinjuku-Ku,
Tokyo 160-8330, Japan
TEL. +81 3 3344 0111 Fax. +81 3 3345 8269
www.keioplaza.com

